

LNO-M

one-piece, divisible, straight, metric 一体式, 可分型, 直型, 公制

In industries, plant construction, machine building as well as in house and electrical installations.

适用于工业装配、厂房建设、机械制造以及房屋和电气装备。

CE

IP54



- High grade, specially formulated polyamide 6
高级特殊改良聚酰胺6制成
- Easy installation and reopening if necessary
易于安装, 如有需要, 可重新打开
- Conduit can be installed in fitting prior to closing
在接头合上前, 软管可预先装入接头内
- Push-in installation of conduit into pre-installed fitting also possible
也可以在预装好的接头内推入安装软管
- High conduit pull-out strength
高抗拉强度
- High impact resistance
高抗冲击力
- Integrated thread sealing lip
集成螺纹密封圈
- Very good chemical properties
非常好的化学性能
- Free from halogens and cadmium
不含卤素和镉
- RoHS and REACH compliant
RoHS 和 REACH 合规性
- Very good UV resistance and weathering characteristics
非常好的抗紫外线和耐候性能
- Fits both conduit profiles - fine (T) and coarse (G)
适用软管类型-细波纹 (T) 和粗波纹 (G)
- Temperature range: -40°C to +105°C; shot-term: +160°C
温度范围: -40°C 至 +105°C; 短期温度: +160°C

Order No. black 订货号 黑色	Thread metric 螺纹 公制	Conduit size 软管规格 NW 标称内径 (mm)	Dimensions 尺寸			Packing unit 包装量 (pcs/PU)
			g (mm)	L (mm)	d2 (mm)	
BLNO-M160	M16 x 1.5	10	13.0	37.5	20.5	50
BLNO-M162	M16 x 1.5	12	13.0	39.5	21.5	50
BLNO-M202	M20 x 1.5	12	13.0	39.5	26.0	50
BLNO-M207	M20 x 1.5	17	13.0	43.5	27.0	50
BLNO-M257	M25 x 1.5	17	14.0	44.5	31.0	50
BLNO-M253	M25 x 1.5	23	14.0	52.5	35.0	30
BLNO-M323	M32 x 1.5	23	17.0	56.0	40.0	30
BLNO-M329	M32 x 1.5	29	17.0	61.0	42.0	20
BLNO-M409	M40 x 1.5	29	21.0	65.0	49.0	20
BLNO-M406	M40 x 1.5	36	22.0	74.5	53.0	20
BLNO-M508	M50 x 1.5	48	22.0	80.5	65.0	10

The above data is given based on "Technical Data Sheet" DB-Nr.24530-05 for reference only.

For details and the most update version, please contact our sales department for "The latest Technical Data Sheet".

以上数据来源于PMA工厂“技术数据表”DB-Nr.24530-05。因厂家会随时更新数据, 故相关数据仅供参考, 如要了解详细和最新技术资料请联系我司销售部索取《最新技术数据表》。

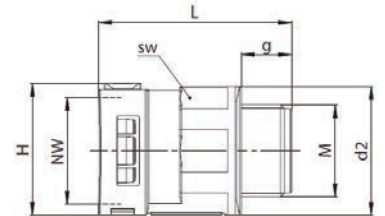

LN-M

divisible lock nuts, metric thread 可分型锁紧螺母, 公制螺纹

In industries, plant construction, machine building as well as in house and electrical installations.

适用于工业装配、厂房建设、机械制造以及房屋和电气装备。

CE



- High-grade, specially formulated polyamide 6
高级, 特殊改良聚酰胺6制成
- Easy installation
便于安装
- Opening with a screwdriver
用螺丝刀打开
- Standard wrench width
标准扳手宽度
- Installation on both sides possible
双面都可以安装
- High impact resistance
高抗冲击强度
- Very good chemical properties
非常好的化学性能
- Free from halogens and cadmium
不含卤素和镉
- RoHS and REACH compliant
RoHS 和 REACH 合规性
- Very good UV resistance and weathering characteristics
非常好的抗紫外线和耐候性能
- Temperature range: -40°C to +105°C; shot-term: +160°C
温度范围: -40°C 至 +105°C; 短期温度: +160°C;

Order No. black 订货号 黑色	Thread metric 螺纹 公制	Fits to connector 适配管接头	Dimensions 尺寸			Packing unit 包装量 (pcs/PU)
			d2 (mm)	SW (mm)	A (mm)	
BLN-M16	M16 x 1.5	BLNO-M160 BLNO-M162	24.0	22	8.0	50
BLN-M20	M20 x 1.5	BLNO-M202 BLNO-M207	29.0	26	8.0	50
BLN-M25	M25 x 1.5	BLNO-M257 BLNO-M253	35.0	32	9.0	10
BLN-M32	M32 x 1.5	BLNO-M323 BLNO-M329	45.0	41	12.0	10
BLN-M40	M40 x 1.5	BLNO-M409 BLNO-M406	55.0	50	15.0	10
BLN-M50	M50 x 1.5	BLNO-M508	66.0	60	15.0	10

The above data is given based on "Technical Data Sheet" DB-Nr.62007-04 for reference only.

For details and the most update version, please contact our sales department for "The latest Technical Data Sheet".

以上数据来源于PMA工厂“技术数据表”DB-Nr.62007-04。因厂家会随时更新数据, 故相关数据仅供参考, 如要了解详细和最新技术资料请联系我司销售部索取《最新技术数据表》。

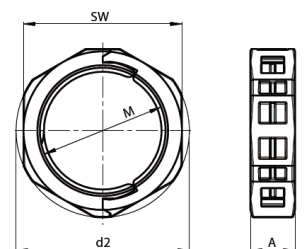

BND

divisible connectors, straight, metric thread 可分型管接头, 直型, 公制螺纹

In industries, plant construction, machine building as well as in house and electrical installations.

适用于工业装配、厂房建设、机械制造以及房屋和电气装备。

IP54



- High-grade, specially formulated polyamide 6
高级, 特殊改良聚酰胺6制成
- Easy installation
易于安装
- Conduit can be pre-installed in fitting before closing
在接头合上前, 软管可预先安装入接头内
- High conduit pull-out strength
高抗拉强度
- Possible to re-open laterally with a screwdriver
用螺丝刀即可重新打开
- Integrated sealing lip
集成密封圈
- Extremely high impact resistance
极高的抗冲击强度
- Very good chemical properties
非常好的化学性能
- Free from halogens and cadmium
不含卤素和镉
- Temperature range: -40°C to +105°C; shot-term: +160°C
温度范围: -40°C 至 +105°C; 短期温度: +160°C

Order No. black 订货号 黑色	Thread metric 螺纹 公制	Conduit size 软管规格 NW 标称内径 (mm)	Dimensions 尺寸			Packing unit 包装量 (pcs/PU)	MOQ 最小起订量 黑色 (pcs)
			g (mm)	L (mm)	Ø D (mm)		
# BND-M207	M20 x 1.5	17	12.5	36.5	27.0	100	100
BND-M253	M25 x 1.5	23	13.5	43.5	34.5	30	-

标记为 # 的产品有最小起订量 (MOQ)

The above data is given based on "Technical Data Sheet" DB-Nr.28001-03 for reference only.

For details and the most update version, please contact our sales department for "The latest Technical Data Sheet".

以上数据来源于PMA工厂“技术数据表”DB-Nr.28001-03。因厂家会随时更新数据, 故相关数据仅供参考, 如要了解详细和最新技术资料请联系我司销售部索取《最新技术数据表》。

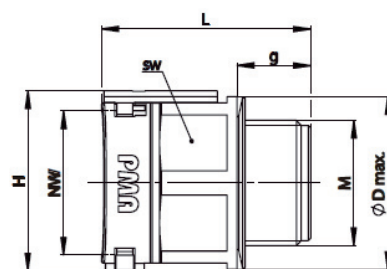

LSGO

connection splice, one-piece, divisible 连接管接头, 一体式, 可分型

In industries, plant construction, machine building as well as in house and electrical installations.

适用于工业装配、厂房建设、机械制造以及房屋和电气装备。



IP40



- High-grade, specially formulated polyamide 6.6
高级, 特殊改良聚酰胺6.6制成
- Easy installation and reopening if necessary
易于安装, 如有需要, 可重新打开
- Conduit can be installed in fitting prior to closing
在接头合上前, 软管可预先安装入接头内
- High conduit pull-out strength
高抗拉强度
- High impact resistance
高冲击强度
- Very good chemical properties
非常好的化学性能
- Free from halogens and cadmium
不含卤素和镉
- RoHS and REACH compliant
RoHS 和 REACH 合规性
- Very good UV resistance and weathering characteristics
非常好的抗紫外线和耐候性能
- Fits both conduit profiles - fine (T) and coarse (G)
适用软管类型 - 细波纹 (T) 和粗波纹 (G)
- Temperature range: -40°C to +105°C; shot-term: +160°C
温度范围: -40°C 至 +105°C; 短期温度: +160°C

Order No. black 订货号 黑色	Conduit size 软管规格 NW 标称内径		Dimensions 尺寸		Packing unit 包装量 (pcs/PU)
	C (mm)	D (mm)	A (mm)	B (mm)	
BLSGO-1010	10	10	36.0	16.0	10
BLSGO-1212	12	12	35.5	19.5	10
BLSGO-1717	17	17	38.5	25.0	10
BLSGO-2323	23	23	39.0	31.5	10

The above data is given based on "Technical Data Sheet" DB-Nr.24545-01 for reference only.

For details and the most update version, please contact our sales department for "The latest Technical Data Sheet".

以上数据来源于PMA工厂“技术数据表”DB-Nr.24545-01。因厂家会随时更新数据, 故相关数据仅供参考, 如要了解详细和最新技术资料请联系我司销售部索取《最新技术数据表》。

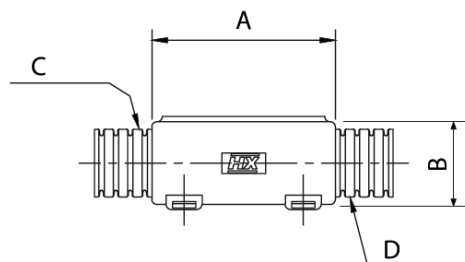

T pieces, divisible T型三通管接头, 可分型

LTO

In industry, plant construction, machine building and electrical installations. For retrofit installation or repair.
适用于工业装配、厂房建设、机械制造以及电气装备。适用于改造安装或维修。

IP40



- High-grade, specially formulated polyamide 6.6
高级, 特殊配方聚酰胺6.6制成
- Easy installation and reopening if necessary
易于安装, 如有需要, 可重新打开
- Conduit can be installed in fitting prior to closing
在接头合上前, 软管可预先安装入接头内
- High conduit pull-out strength
高抗拉强度
- High impact resistance
高抗冲击能力
- Very good chemical properties
非常好的化学性能
- Free from halogens and cadmium
不含卤素和镉
- RoHS and REACH compliant
RoHS 和 REACH 合规性
- Very good UV resistance and weathering characteristics
非常好的抗紫外线和耐候性能
- Ingress protection: IP40
防护等级: IP40
- Fits both conduit profiles - fine (T) and coarse (G)
适用软管类型 - 细波纹 (T) 和粗波纹 (G)
- Temperature range: -40°C to +105°C; shot-term: +160°C
温度范围: -40°C 至 +105°C; 短期温度: +160°C

标记为 # 的产品有最小起订量 (MOQ)

Order No. black 订货号 黑色	Conduit size 软管规格 NW 标称内径			Dimensions 尺寸		Packing unit 包装量 (pcs/PU)	MOQ 最小起订量 黑色 (pcs)
	C (mm)	D (mm)	E (mm)	A (mm)	B (mm)		
BLTO-070707	07	07	07	45.2	31.1	10	-
BLTO-101010	10	10	10	45.2	31.1	10	-
# BLTO-121212	12	12	12	49.1	34.8	10	10
# BLTO-171717	17	17	17	56.5	41.0	10	10
BLTO-232323	23	23	23	64.5	48.6	10	-
# BLTO-292929	29	29	29	72.0	55.3	10	10

The above data is given based on "Technical Data Sheet" DB-Nr.24535-03 for reference only.
For details and the most update version, please contact our sales department for "The latest Technical Data Sheet".
以上数据来源于PMA工厂“技术数据表”DB-Nr.24535-03。因厂家会随时更新数据, 故相关数据仅供参考, 如要了解详细和最新技术资料请联系我司销售部索取《最新技术数据表》。

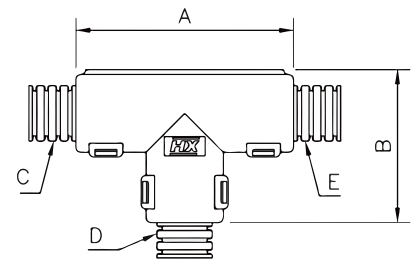

Y pieces, divisible Y型三通管接头, 可分型

LYO

In industry, plant construction, machine building and electrical installations. For retrofit installation or repair.
适用于工业装配、厂房建设、机械制造以及电气装备。适用于改造安装或维修。



IP40



- High-grade, specially formulated polyamide 6.6
高级, 特殊配方聚酰胺6.6制成
- Easy installation and reopening if necessary
易于安装, 如有需要, 可重新打开
- Conduit can be installed in fitting prior to closing
在接头合上前, 软管可预先安装入接头内
- High conduit pull-out strength
高抗拉强度
- High impact resistance
高抗冲击能力
- Very good chemical properties
非常好的化学性能
- Free from halogens and cadmium
不含卤素和镉
- RoHS and REACH compliant
RoHS 和 REACH 合规性
- Very good UV resistance and weathering characteristics
非常好的抗紫外线和耐候性能
- Ingress protection: IP40
防护等级: IP40
- Fits both conduit profiles - fine (T) and coarse (G)
适用软管类型 - 细波纹 (T) 和粗波纹 (G)
- Temperature range: -40°C to +105°C; shot-term: +160°C
温度范围: -40°C 至 +105°C; 短期温度: +160°C

标记为 # 的产品有最小起订量 (MOQ)

Order No. black 订货号 黑色	Conduit size 软管规格 NW 标称内径			Dimensions 尺寸					Packing unit 包装量 (pcs/PU)	MOQ 最小起订量 黑色 (pcs)
	F (mm)	G (mm)	H (mm)	A (mm)	B (mm)	C (mm)	D (mm)	E (mm)		
BLYO-100707	10	07	07	54.6	37.1	10.0	10.0	10.0	10	-
BLYO-121010	12	10	10	54.9	39.8	10.0	10.0	10.0	10	-
BLYO-171212	17	12	12	63.6	47.5	12.0	10.0	10.0	10	-
# BLYO-231717	23	17	17	76.5	60.0	13.0	11.0	11.0	10	10
BLYO-292917	29	29	17	100.6	76.0	13.0	13.0	13.0	10	-

The above data is given based on "Technical Data Sheet" DB-Nr.24540-03 for reference only.
For details and the most update version, please contact our sales department for "The latest Technical Data Sheet".
以上数据来源于PMA工厂“技术数据表”DB-Nr.24540-03。因厂家会随时更新数据, 故相关数据仅供参考, 如要了解详细和最新技术资料请联系我司销售部索取《最新技术数据表》。

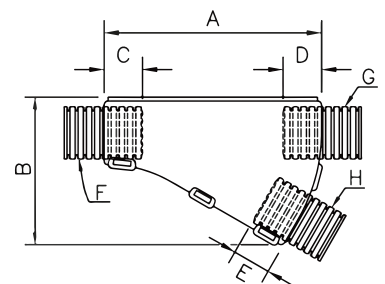

PACOF flexible, divisible, medium-duty 柔软, 可分型, 中壁

Rail, machine building and many other applications. 适用于铁路, 机械制造和许多其他的应用场合。



- Specially modified polyamide 6
特殊改良聚酰胺6
- Easy installation and reopening if necessary
易于安装, 如有需要, 可重新打开
- PMA standard nominal widths can be used in combination with all PMA fittings and accessories
符合PMA标称内径, 可适配所有PMA标准管接头和附件
- Applicable also for repairs
可应用于维修
- Trouble-free retrofitting
无忧再改装
- Self-extinguishing
自熄灭性
- Free from halogens and cadmium
不含卤素和镉
- RoHS and REACH compliant
RoHS 和 REACH 合规性
- Very good UV resistance and weathering characteristics
非常好的抗紫外线和耐候性能
- EN 45545-2 HL3 (R22 & R23)
HL3. 根据EN45545-2车内软管R22/车外软管R23 标准
- NFPA 130
NFPA 130
- Temperature range: -40°C to +105°C; shot-term: +160°C
温度范围: -40°C 至 +105°C; 短期温度: +160°C

Order No. black 订货号 黑色	Conduit size 软管规格 NW 标称内径 (mm)	Fits to thread metric 适配螺纹 公制 (mm)	Inside diameter 内径 (mm)	Outside diameter 外径 (mm)	Stat. ** radius 静态弯曲 半径 (mm)	PU meter 包装单位 米 (m)
PACOF-07B	07	M12 x 1.5	5.6	10.0	30	50
PACOF-10B	10	M12 x 1.5	8.5	12.8	33	50
PACOF-12B	12	M16 x 1.5	11.0	15.6	35	50
PACOF-17B	17	M20 x 1.5	15.5	21.1	45	50
PACOF-23B	23	M25 x 1.5	22.1	28.4	70	50
PACOF-29B	29	M32 x 1.5	27.2	34.5	120	50
PACOF-36B	36	M40 x 1.5	32.0	42.4	145	30
PACOF-48B	48	M50 x 1.5	43.9	54.5	150	30
PACOF-70B	70	-	62.2	79.0	190	10

The above data is given based on "Technical Data Sheet" DB-Nr.10920-20 for reference only.
For details and the most update version, please contact our sales department for "The latest Technical Data Sheet".
以上数据来源于PMA工厂“技术数据表”DB-Nr.10920-20。因厂家会随时更新数据, 故相关数据仅供参考, 如要了解详细和最新技术资料请联系我司销售部索取《最新技术数据表》。

PACOF-Index	
min.	max.
ductility	柔软性
fatigue reversed bending	抗弯性
compression resistance	抗压性
low temperature performance	抗冻性
weathering resistance	耐候性

PACOF flexible, divisible 柔软, 可分型

In machine building and plant construction. **To be discontinued.** 应用于机械制造和厂房建设。即将停用。



- Specially modified polyamide 6
特殊改良聚酰胺6
- Can be opened and closed again in longitudinal direction any time
软管纵向可多次打开和闭合
- Easy installation
安装方便
- Trouble-free retrofitting
无忧再改装
- Applicable also for repairs
可应用于维修
- Self-extinguishing
自熄灭性
- Free from halogens and cadmium
不含卤素和镉
- Temperature range: -40°C to +105°C; shot-term: +160°C
温度范围: -40°C 至 +105°C; 短期温度: +160°C

Order No. black 订货号 黑色	Inside diameter 内径 (mm)	Outside diameter 外径 (mm)	Stat. ** radius 静态弯曲 半径 (mm)	PU meter 包装单位 米 (m)
PACOF-14B	13.0	19.0	42	50
PACOF-20B	19.1	25.5	55	50
PACOF-26B	24.0	31.6	80	50

The above data is given based on "Technical Data Sheet" DB-Nr.10921-00 for reference only.
For details and the most update version, please contact our sales department for "The latest Technical Data Sheet".
以上数据来源于PMA工厂“技术数据表”DB-Nr.10921-00。因厂家会随时更新数据, 故相关数据仅供参考, 如要了解详细和最新技术资料请联系我司销售部索取《最新技术数据表》。

PACOF-Index	
min.	max.
ductility	柔软性
fatigue reversed bending	抗弯性
compression resistance	抗压性
low temperature performance	抗冻性
weathering resistance	耐候性

PPCOF

flexible, divisible, medium-duty 柔软, 可分型, 中壁

In machine building and plant construction. 应用于机械制造和厂房建设。

CE



- Specially modified polypropylene PP
特殊改良聚丙烯
- Easy installation and reopening if necessary
易于安装, 如有需要, 可重新打开
- PMA standard nominal widths can be used in combination with all PMA fittings and accessories
符合PMA标称内径, 可适配所有PMA标准管接头和附件
- Trouble-free retrofitting
无忧再改装
- Applicable also for repairs
可应用于维修
- Self-extinguishing
自熄灭性
- RoHS and REACH compliant
RoHS 和 REACH 合规性
- Good UV resistance and weathering characteristics
良好的抗紫外线和耐候性能
- Temperature range: -20°C to +105°C; short-term: +150°C
温度范围: -20°C 至 +105°C; 短期温度: +150°C

Order No. black 订货号 黑色	Conduit size 软管规格 NW 标称内径 (mm)	Fits to thread metric 适配螺纹 公制 (mm)	Inside diameter 内径 (mm)	Outside diameter 外径 (mm)	Stat.** radius 静态弯曲 半径 (mm)	PU meter 包装单位 米 (m)
PPCOF-07B	07	M12 x 1.5	5.6	10.0	25	50
PPCOF-10B	10	M12 x 1.5	8.5	12.8	28	50
PPCOF-12B	12	M16 x 1.5	11.0	15.6	35	50
PPCOF-17B	17	M20 x 1.5	15.1	21.1	45	50
PPCOF-23B	23	M25 x 1.5	22.1	28.4	60	50
PPCOF-29B	29	M32 x 1.5	26.6	34.5	100	50
PPCOF-36B	36	M40 x 1.5	31.8	42.4	120	30
PPCOF-48B	48	M50 x 1.5	43.9	54.5	140	30
PPCOF-70B	70	-	60.5	78.0	200	10

The above data is given based on "Technical Data Sheet" DB-Nr.10930-13 for reference only.

For details and the most update version, please contact our sales department for "The latest Technical Data Sheet".

以上数据来源于PMA工厂“技术数据表”DB-Nr.10930-13。因厂家会随时更新数据, 故相关数据仅供参考, 如要了解详细和最新技术资料请联系我司销售部索取《最新技术数据表》。

PPCOF-Index

min.	max.
ductility	柔软性
fatigue reversed bending	抗弯性
compression resistance	抗压性
low temperature performance	抗冻性
weathering resistance	耐候性

EWZ**draw-in tool** 穿引工具

Can be used whenever a drawing-in assistance for slit and divisible conduits is helpful. 可用于带有狭缝软管和可分型软管的电缆穿引。

CE

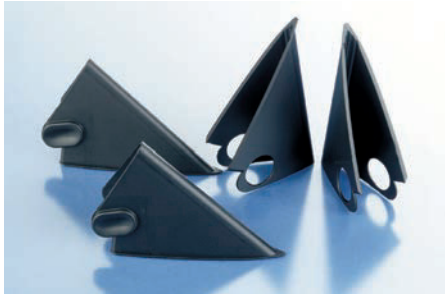

Order No. black with hole 订货号 黑色带孔	Order No. black with handle 订货号 黑色带把手	Conduit size 软管规格 NW 标称内径 (mm)	Dimensions 尺寸			Packing unit 包装量 (pcs/PU)	MOQ 最小起订量 black with handle 黑色带把手 (pcs)
			L (mm)	H (mm)	B (mm)		
EWZ-02	# EWZ-03	7.5 - 34	117.7	71.9	45.2	100/50	50

标记为 # 的产品有最小起订量 (MOQ)

The above data is given based on "Technical Data Sheet" DB-Nr.69010-04 for reference only.

For details and the most update version, please contact our sales department for "The latest Technical Data Sheet".

以上数据来源于PMA工厂“技术数据表”DB-Nr.69010-04。因厂家会随时更新数据，故相关数据仅供参考，如要了解详细和最新技术资料请联系我司销售部索取《最新技术数据表》。

- Specially formulated polyamide 6.6
特殊配方聚酰胺6.6制成
- Easy draw-in for single and several cables/wires suitable for slit conduits or PMA Divisible System conduits
易于电缆穿引-适用于将单根和多根电缆/电线穿进带有狭缝软管或PMA可分软管
- Designed in a handy shape
设计上外形简单
- Equipped with a practical hand grip for clamping or with hole for direct holding of the wires
带有实用的把手或直接插入电线的孔方便电缆穿引。

with hole:

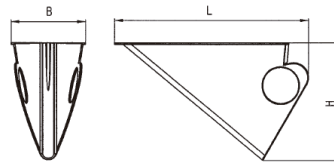

with handle:

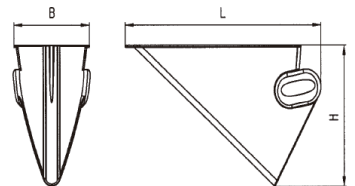

FH-O

one-piece system supports 单个软管固定卡子

In machine building and installation applications. 适用于机械及安装系统。



Order No. black 订货号 黑色	Order No. grey 订货号 灰色	Conduit size 软管规格 NW 标称内径 (mm)	Dimensions 尺寸						Packing unit 包装量 (pcs/PU)
			H (mm)	M (mm)	E (mm)	A (mm)	B (mm)	C (mm)	
BFH-07-0	SFH-07-0	07	13.5	M4	40.5	17.0	20.0	21.5	100
BFH-10-0	SFH-10-0	10	15.5	M5	47.5	20.5	20.0	24.5	100
BFH-12-0	SFH-12-0	12	16.5	M5	54.5	24.0	20.0	27.0	100
BFH-17-0	SFH-17-0	17	20.0	M6	68.0	30.0	20.0	34.0	100
BFH-23-0	SFH-23-0	23	24.0	M6	85.0	38.5	20.0	42.0	100
BFH-29-0	SFH-29-0	29	27.0	M6	99.0	45.5	20.0	48.0	100
BFH-36-0	SFH-36-0	36	31.0	M6	119.0	55.5	20.0	56.0	50
BFH-48-0	SFH-48-0	48	37.0	M6	143.0	67.5	20.0	68.0	20

- High-grade, specially formulated polyamide 6 高级, 特殊配方聚酰胺6制成
- One-piece construction 一体式结构
- Very high impact resistance 非常高的抗冲击强度
- Optimal axial strain relief due to integrated rib 集成的肋状凸起设计, 有效消除轴向应力
- Suitable for overhead installations due to safety lid 由于自带安全盖, 适用于高架安装
- High retention forces 高保持力
- Quick mounting due to single hole fixing 通过单孔快速安装
- Very good chemical properties 非常好的化学性能
- Free from halogens and cadmium 不含卤素和镉
- RoHS and REACH compliant RoHS 和 REACH 合规性
- Very good UV resistance and weathering characteristics, particularly in black 非常好的抗紫外线和耐候性能, 尤其是黑色
- Fits to PMA CLIP - BFHS - Rail for system support 适配于 PMA CLIP - BFHS 导轨系统
- Fits both conduit profiles - fine (T) and coarse (G) 适用软管类型 - 细波纹 (T) 和粗波纹 (G)
- Temperature range: -50°C to +105°C; short-term to +160°C 温度范围: -50°C 至 +105°C; 短期温度: +160°C

The above data is given based on "Technical Data Sheet" DB-Nr.40001-07 for reference only. For details and the most update version, please contact our sales department for "The latest Technical Data Sheet". 以上数据来源于PMA工厂“技术数据表”DB-Nr.40001-07。因厂家会随时更新数据, 故相关数据仅供参考, 如要了解详细和最新技术资料请联系我司销售部索取《最新技术数据表》。

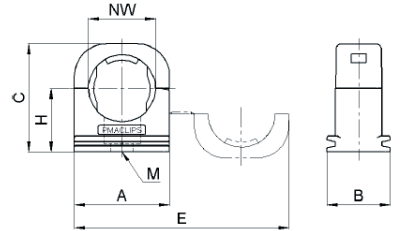

SGB

tube clamps 管夹

In wide range of applications in all industries. 在工业行业中被广泛的应用。



Order No. 订货号	Conduit size 软管规格 NW 标称内径 (mm)	d1 (mm)	Dimensions 尺寸				Packing unit 包装量 (pcs/PU)	MOQ 最小起订量 (pcs)
			A (mm)	B (mm)	C (mm)	M (mm)		
SGB-07	07	10.0	22.1	13.0	10.2	M4	100	-
# SGB-07-6.4	07	10.0	32.3	19.0	16.2	M6	100	100
SGB-09	10	12.0	24.6	13.0	11.7	M4	100	-
# SGB-09-6.4	10	12.0	34.3	19.0	17.2	M6	100	100
# SGB-09-8.4	10	12.0	41.3	25.0	20.5	M8	100	100
SGB-11	12	15.0	27.6	13.0	13.2	M4	100	-
# SGB-11-6.4	12	15.0	37.5	19.0	18.7	M6	100	100
# SGB-11-8.4	12	15.0	44.3	25.0	22.0	M8	100	100
SGB-16	17	21.0	37.5	15.0	16.5	M5	100	-
# SGB-16-6.4	17	21.0	43.5	19.0	21.7	M6	100	100
# SGB-16-8.4	17	21.0	50.3	25.0	25.0	M8	100	100
SGB-21	23	28.0	44.9	15.0	22.0	M5	50	-
# SGB-21-6.4	23	28.0	50.5	19.0	25.2	M6	50	100
# SGB-21-8.4	23	28.0	55.7	25.0	28.5	M8	50	100
SGB-29	29	34.0	55.9	19.0	28.2	M6	30	-
# SGB-29-8.4	29	34.0	61.5	25.0	31.5	M8	30	1200
SGB-36	36	41.0	63.5	19.0	31.7	M6	20	-
# SGB-36-8.4	36	41.0	70.5	25.0	35.0	M8	20	100
SGB-48	48	53.0	74.9	19.0	37.7	M6	20	-
# SGB-48-8.4	48	53.0	82.5	25.0	41.0	M8	20	100

- Clamp: galvanized steel (stainless steel available on request) 钢制镀锌 (可根据要求提供不锈钢)
- Profile: elastomer (EPDM) 外包弹性体 (EPDM)
- For the mounting of static conduits 用于静态软管安装
- Smooth connection to PMA FLEX corrugated conduits 平滑固定PMA FLEX软管
- Good resistance to ozone and ageing 良好的抗臭氧和耐老化性能
- Free from halogens and cadmium 不含卤素和镉
- RoHS and REACH compliant RoHS 和 REACH 合规性
- Conforms to: DIN 3016 符合 DIN 3016 标准
- Temperature range: -50°C to +105°C; short-term to +160°C 温度范围: -50°C 至 +105°C; 短期温度: +160°C

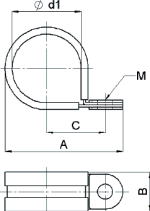

标记为 # 的产品有最小起订量 (MOQ)

The above data is given based on "Technical Data Sheet" DB-Nr.60020-18 for reference only. For details and the most update version, please contact our sales department for "The latest Technical Data Sheet". 以上数据来源于PMA工厂“技术数据表”DB-Nr.60020-18。因厂家会随时更新数据, 故相关数据仅供参考, 如要了解详细和最新技术资料请联系我司销售部索取《最新技术数据表》。